

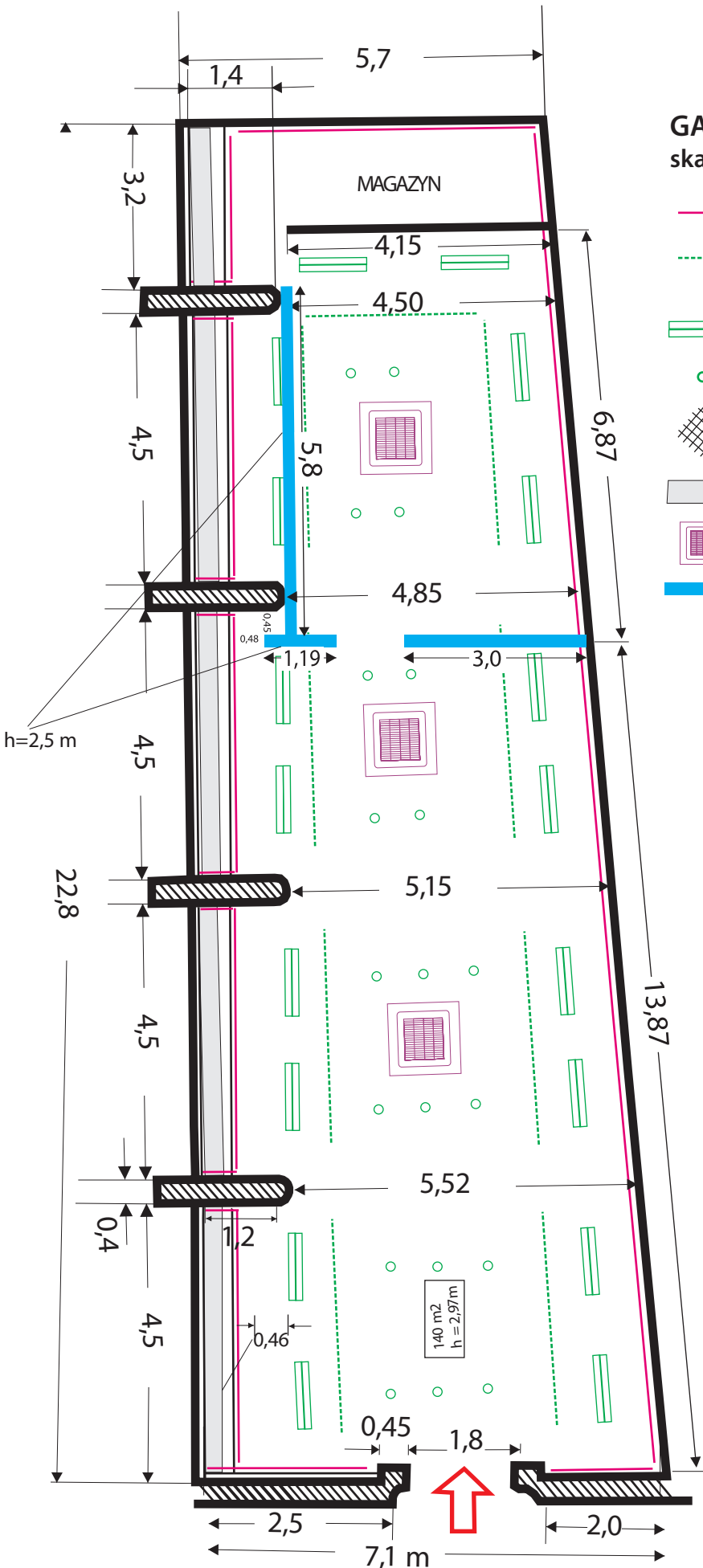







GALERIA BIELSKA BWA - SALA DOLNA

skala 1 : 100

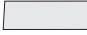

-  1. pręty do zawieszania na wszystkich ścianach
-  2. szynoprzewody do montażu oświetlenia (halogeny 20W /830 EB36)
-  3. jarzeniówki
-  4. halogeny w suficie (oczka)
-  5. fragment posadzki (płytki szare 30 x 30 cm, ułożone diagonalnie)
-  6. osłony kaloryferów (wys. 55 cm, głębokość 46 cm)
-  7. klimatyzator (pod sufitem)
-  8. ścianki tymczasowe

